

Montageanleitung



(GB) Mounting instruction

(PL) montaż instrukcje

(RU) сборка инструкции

(FR) Assemblée directives

(SK) montáž navodila

(HU) gyűlés utasítás

(NL) montage instructies

(TR) montaj talimatlar

(IT) montaggio istruzioni

(RO) asamblare instrucțiuni

(CZ) montáž instrukce

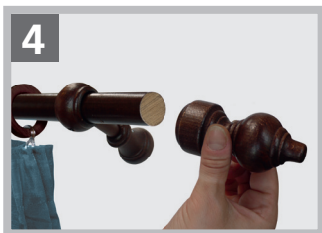
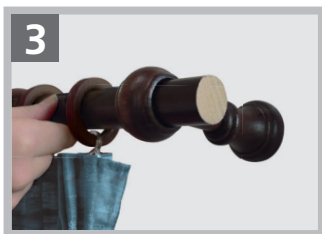
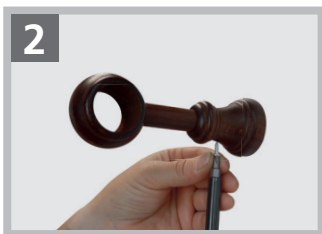
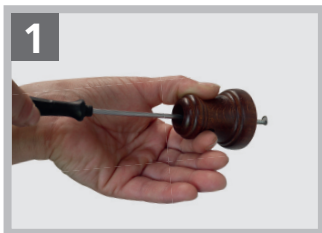



Holz aus nachhaltigem Anbau –
für eine ökologisch verantwortungsvolle
Waldbewirtschaftung